

# PRODUCT DATA SHEET

# CAPIT JOIST SEAL Cx225/xx

MATERIAL: INJECTION-MOULDED POLYPROPYLENE. THE JOIST SEAL IS MOULDED SO AS TO HAVE CONVERGING SIDES WHICH BECOME PARALLEL AND GRIP THE JOIST END WHEN FITTED TO A JOIST OF THE NOMINAL SIZE.

### AS MOULDED

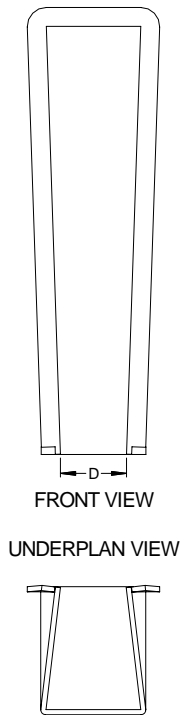

### AS FITTED

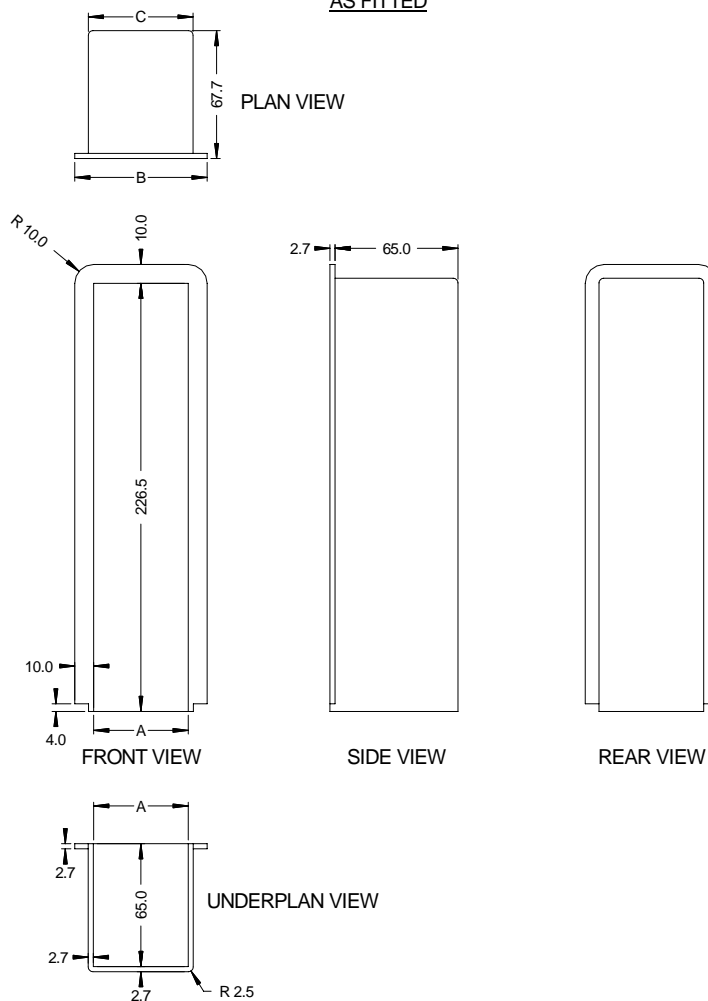

3rd ANGLE PROJECTION. ALL DIMENSIONS IN mm UNLESS OTHERWISE STATED. WALL THICKNESS TOLERANCE  $\pm 0.25$ mm. ALL OTHER TOLERANCES  $\pm 1$ mm.

MAX. JOIST WIDTH	MAX. JOIST HEIGHT	MIN. BLOCK THICKNESS	ORDER CODE	COLOUR	DIMENSIONS				WEIGHT
					A	B	C	D	
38	225	85	CB225/38	BLUE	38.0	58.0	43.4	31 $\pm$ 5	106 g
50			CY225/50	YELLOW	50.0	70.0	55.4	35 $\pm$ 5	112 g
60			CG225/60	GREEN	60.0	80.0	65.4	43 $\pm$ 5	120 g
75			CR225/75	RED	75.0	95.0	80.4	66 $\pm$ 5	128 g
100			CW225/100	WHITE	100.0	120.0	105.4	93 $\pm$ 5	148 g

The CAPIT joist seal is an open-fronted and open-bottomed box that is injection-moulded in polypropylene. It is fitted over the end of a joist that is to be built into a wall. The sides of the box converge slightly so that the seal grips the joist while the wall is built around it. As the wall is built, a flange around the open front of the joist seal becomes embedded in the mortar to seal the CAPIT to the wall. Once the wall has been built, the CAPIT joist seal is completely concealed behind the front face of the wall. When used with a traditional timber joist which, in time, shrinks or splits, the CAPIT joist seal serves to limit air leakage through the wall. When used with an engineered I-beam joist, the CAPIT joist seal blocks any air passageways that may remain between the web and flanges of the joist and the surrounding structure.



CAPIT BUILDING PRODUCTS LIMITED  
AVRO WAY  
BOWERHILL INDUSTRIAL ESTATE  
MELKSHAM, WILTSHIRE  
SN12 6TP

TEL: 01225 791124  
FAX: 01225 700860  
EMAIL: tech@capit-building-products.co.uk  
WEB: www.capit-building-products.co.uk

DRAWN BY: KST  
DATE: 25/08/2007  
DRAWING No. CJSPDS  
PATENTED: GB 2394234  
GB2420799 GB2426987

